



## 1. Feature

- ▶ High Performance
- ▶ High Reliability
- ▶ RoHS Compliant

Directional Coupler

Part No: CDC01000M04000A20

Date: April.15<sup>th</sup>.2019

Revision No: Preliminary

## 2. Electrical Specifications

Parameter	Specification	Remark
Frequency Range	1000-4000MHz	
Nominal Coupling	20±1dB	
Coupling Sensitivity	≤±0.7dB	
Insertion Loss	≤0.5dB	
VSWR	≤1.20	
Directivity	≥20dB	
Forward Power	50W	
Impedance	50Ω	

## 3. Mechanical Specifications

Parameter	Specifications	Remark
Dimensions	73.0x15.0x11.0mm	
Connector Type	SMA-female	
Surface Finish	Grey Painting	

## 4. Temperature Specifications

Parameter	Specifications	Remark
Operational Temperature	-40 to +80 °C	
Storage Temperature	-55 to +85 °C	

5. Outline Drawing ( $\pm 0.3\text{mm}$ )



CONCEPT

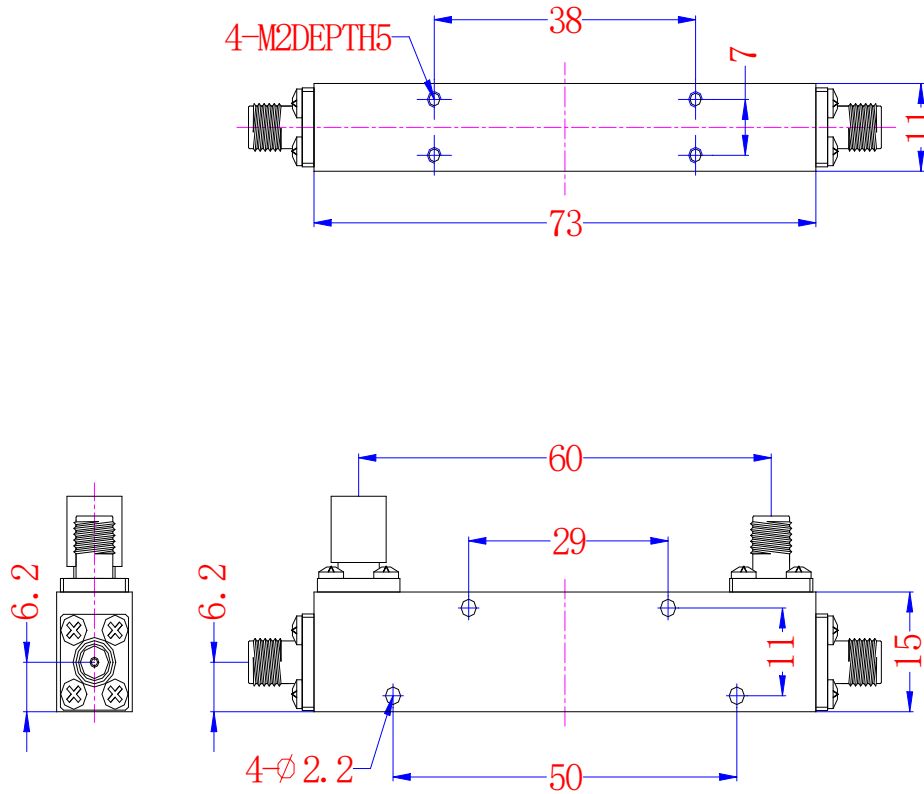

## 6. Test Curves



### Insertion Loss

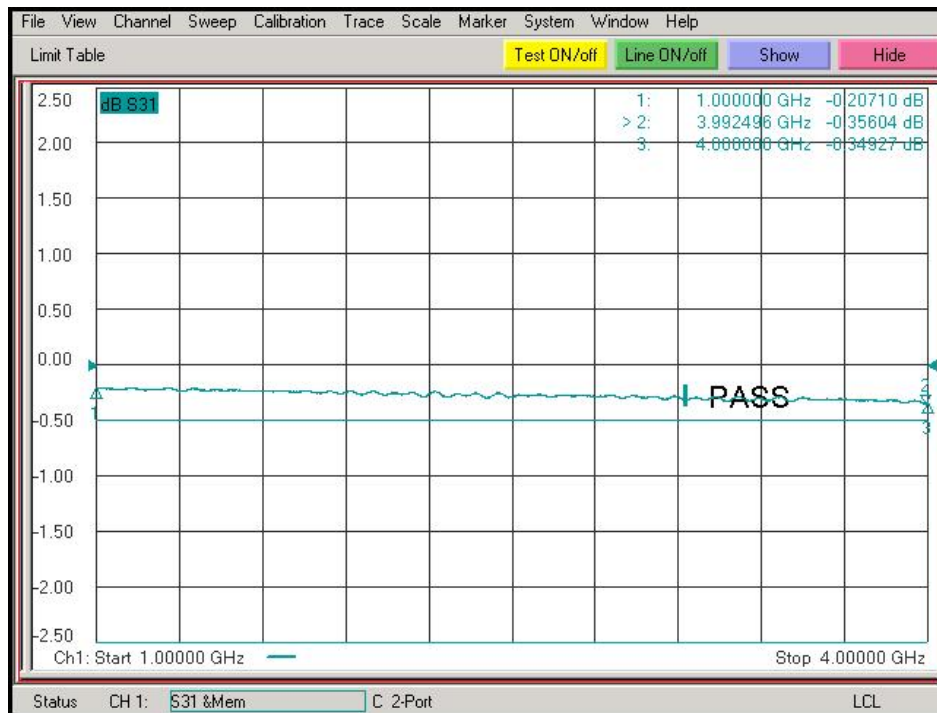

### Coupling Flatness VSWR

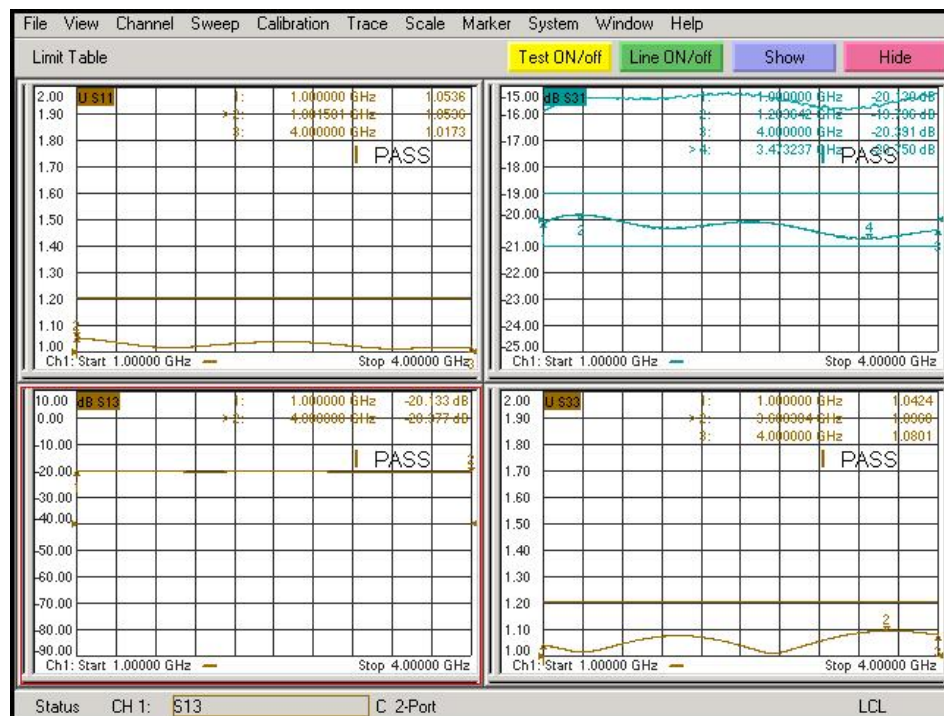



### Directivity

