



1. Feature

- ▶ High Performance
- ▶ High Reliability
- ▶ RoHS Compliant

Directional Coupler

Part No: CDC01000M04000A10

Date: April.15th.2019

Revision No: Preliminary

2. Electrical Specifications

Parameter	Specification	Remark
Frequency Range	1000-4000MHz	
Nominal Coupling	10±1dB	
Coupling Sensitivity	≤±0.7dB	
Insertion Loss	≤0.5dB (Exclusive the 0.45dB Coupled loss)	
VSWR	≤1.20	
Directivity	≥20dB	
Forward Power	50W	
Impedance	50Ω	

3. Mechanical Specifications

Parameter	Specifications	Remark
Dimensions	73.0x15.0x11.0mm	
Connector Type	SMA-female	
Surface Finish	Grey Painting	

4. Temperature Specifications

Parameter	Specifications	Remark
Operational Temperature	-40 to +80 °C	
Storage Temperature	-55 to +85 °C	

5. Outline Drawing ($\pm 0.3\text{mm}$)



CONCEPT

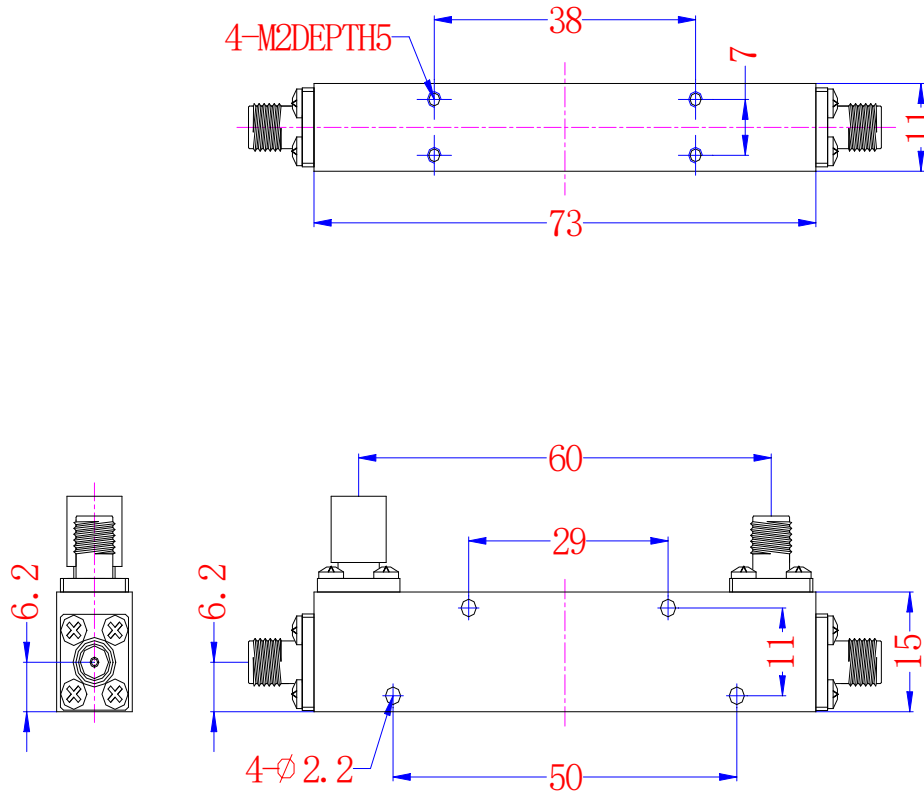

6. Test Curves



Insertion Loss

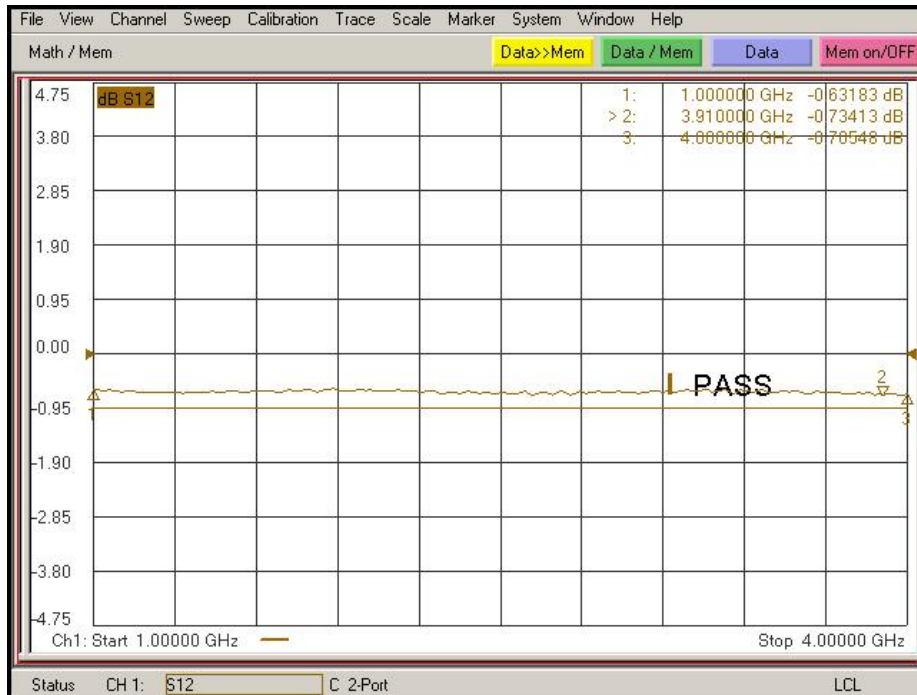

Coupling Flatness and VSWR





Directivity

