



1. Feature

- ▶ High Performance
- ▶ High Reliability
- ▶ RoHS Compliant

Lowpass Filter

Part No: CLF00000M06000N01

Date: Oct.18th.2022

Revision No: Preliminary

2. Electrical Specifications

Parameter	Specification	Remark
Passband	DC-6000MHz	
Insertion loss	≤1.0dB	
VSWR	≤1.8	
Rejection	≥70dB@8000-12000MHz	
Average Power	≤200W	
Impedance	50Ω	

3. Mechanical Specifications

Parameter	Specifications	Remark
Dimensions	85.0x26.0x18.0mm	
Connector Type	N-female	
Surface Finish	Black Painting	

4. Temperature Specifications

Parameter	Specifications	Remark
Operational Temperature	-40 to +80 °C	
Storage Temperature	-45 to +85 °C	



5. Outline Drawing ($\pm 0.5\text{mm}$)

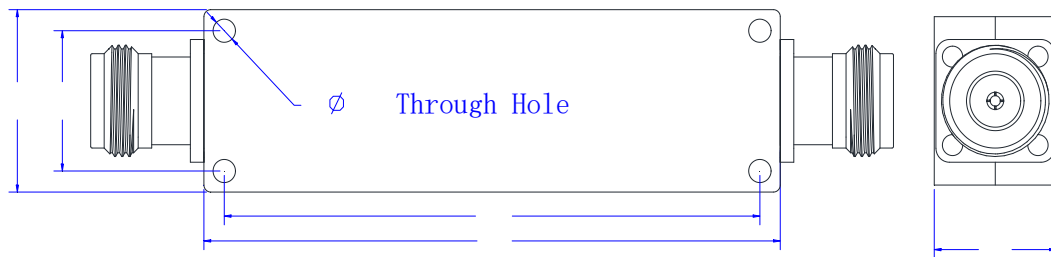

6. Test Curve

