



## 1. Feature

- ▶ High Performance
- ▶ High Reliability
- ▶ RoHS Compliant

Lowpass Filter

Part No: CLF00000M12000N01

Date: Oct.18<sup>th</sup>.2022

Revision No: Preliminary

## 2. Electrical Specifications

Parameter	Specification	Remark
Passband	DC-12000MHz	
Insertion loss	≤1.0dB	
VSWR	≤1.8	
Rejection	≥70dB@17000-25500MHz	
Average Power	≤200W	
Impedance	50Ω	

## 3. Mechanical Specifications

Parameter	Specifications	Remark
Dimensions	45.0x24.0x18.0mm	
Connector Type	N-female	
Surface Finish	Black Painting	

## 4. Temperature Specifications

Parameter	Specifications	Remark
Operational Temperature	-40 to +80 °C	
Storage Temperature	-45 to +85 °C	



**5. Outline Drawing ( $\pm 0.5\text{mm}$ )**

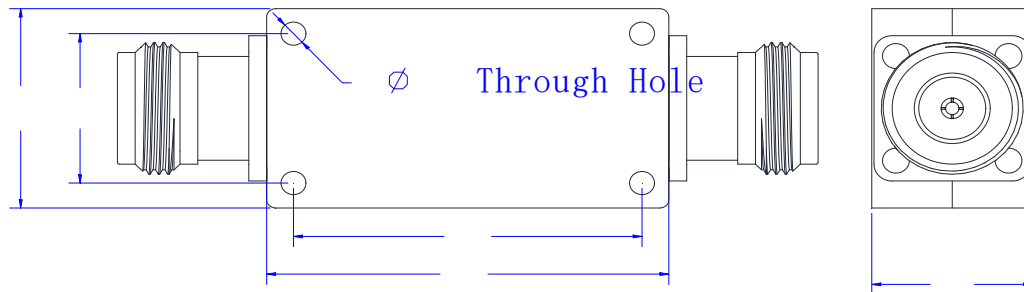

6. Test Curve

