



1. Feature

- ▶ High Performance
- ▶ High Reliability
- ▶ RoHS Compliant

Notch Filter

Part No: CNF07900M08400A01

Date: May.25th.2020

Revision No: A1

2. Electrical Specifications

Parameter	Specification	Remark
Notch Band	7900-8400MHz	
Rejection	≥50dB	
Passband	DC-7800MHz & 8500-18000MHz	
Insertion loss	≤3.0dB	
VSWR	≤2.0	
Average Power	≤20W	
Impedance	50Ω	

3. Mechanical Specifications

Parameter	Specifications	Remark
Dimensions	63.5 x 25.4 x 12.7 mm (Not including the tuning screws and connectors)	
Connector Type	SMA- Female (Stainless Steel)	
Surface Finish	Black Painting	

4. Temperature Specifications

Parameter	Specifications	Remark
Operational Temperature	0 to + 60 °C	
Storage Temperature	-55 to +85 °C	

5.Outline Drawing ($\pm 0.5\text{mm}$)

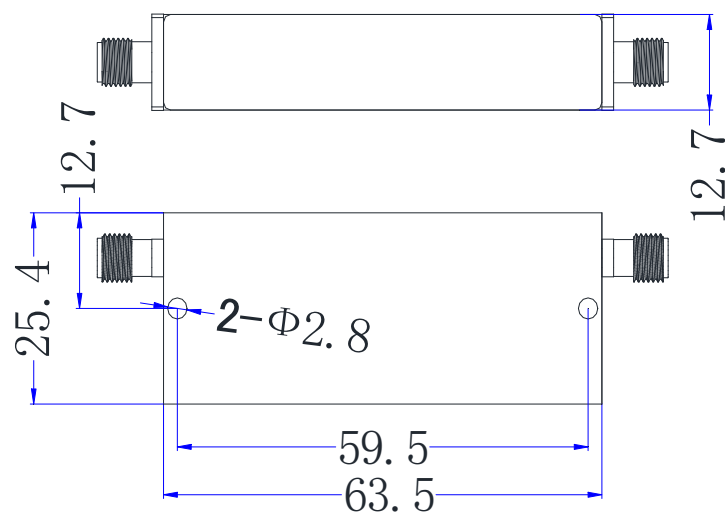

6. Test Curve

